

TM 9-2320-279-24P-1

This Manual In Conjunction with TM 9-2320-279-24P-2 supersedes TM 9-2320-279-20P, TM 9-2320-279-34P-1, TM 9-2320-279-34P-2 and Appendix B of TM 9-2815-224-34&P in their entirety.

TECHNICAL MANUAL

UNIT, DIRECT SUPPORT AND GENERAL SUPPORT MAINTENANCE REPAIR PARTS AND SPECIAL TOOLS LIST

FOR

M977 SERIES, 8 x 8 HEAVY EXPANDED MOBILITY TACTICAL TRUCKS (HEMTT)

MODEL	NSN	EIC
TRUCK, CARGO, WITH WINCH M977	2320-01-097-0260	B2D
TRUCK, CARGO, WITHOUT WINCH M977	2320-01-099-6426	B2G
TRUCK, TANK, FUEL, WITH WINCH M978	2320-01-097-0249	B2C
TRUCK, TANK, FUEL WITHOUT WINCH M978	2320-01-100-7672	B2H
TRUCK, TRACTOR, WITH WINCH, WITHOUT CRANE M983	2320-01-097-0247	B2A
TRUCK, WRECKER-RECOVERY M984	2320-01-097-0248	B2B
TRUCK, WRECKER-RECOVERY M984A1	2320-01-195-7641	B2L
TRUCK, CARGO, WITH WINCH M985	2320-01-097-0261	B2E
TRUCK, CARGO, WITHOUT WINCH M985	2320-01-100-7673	B2J
TRUCK, CARGO, WITH WINCH M985E1	2320-01-194-7032	B2K

APPROVED FOR PUBLIC RELEASE; DISTRIBUTION IS UNLIMITED

HEADQUARTERS, DEPARTMENT OF THE ARMY

15 D E C E M B E R 1998

TECHNICAL MANUAL

No. 9-2320-279-24P
Change 2

HEADQUARTERS
DEPARTMENT OF THE ARMY
Washington, D.C., 15 December 1998

**UNIT, DIRECT SUPPORT AND GENERAL SUPPORT MAINTENANCE
REPAIR PARTS AND SPECIAL TOOLS LIST
FOR
M977 SERIES, 8 X 8 HEAVY EXPANDED MOBILITY
TACTICAL TRUCKS (HEMTT)**

MODEL	NSN	EIC
TRUCK, CARGO, WITH WINCH, M977	NSN 2320-01-097-0260	B2D
TRUCK, CARGO, WITHOUT WINCH, M977	NSN 2320-01-099-6426	B2G
TRUCK, TANK, FUEL, WITH WINCH, M978	NSN 2320-01-097-0249	B2C
TRUCK, TANK, FUEL, WITHOUT WINCH, M978	NSN 2320-01-100-7672	B2H
TRUCK, TRACTOR, WITH WINCH, WITHOUT CRANE, M983	NSN 2320-01-097-0247	B2A
TRUCK, WRECKER-RECOVERY, M984	NSN 2320-01-097-0248	B2A
TRUCK, WRECKER-RECOVERY, M984A1	NSN 2320-01-195-7641	B2L
TRUCK, CARGO, WITH WINCH, M985	NSN 2320-01-097-0261	B2E
TRUCK, CARGO, WITHOUT WINCH, M985	NSN 2320-01-100-7673	B2J
TRUCK, CARGO, WITH WINCH, M985E1	NSN 2320-01-194-7032	B2K

Current as of April 1, 1998

REPORTING ERRORS AND RECOMMENDING IMPROVEMENTS

You can help improve this publication. If you find any mistakes or if you know of a way to improve the procedures, please let us know. Submit your DA Form 2028-2 (Recommended Changes to Equipment Technical Publications), through the Internet, on the Army Electronic Product Support (AEPS) Web site. The Internet address is <http://aeprs.ria.army.mil>. If you need a password, scroll down and click on "ACCESS REQUEST FORM." The DA Form 2028 is located in the ONLINE FORMS PROCESSING section of the AEPS. Fill out the form and click on SUBMIT. Using this form on the AEPS will enable us to respond quicker to your comments and better manage the DA Form 2028 program. You may also mail, fax, or e-mail your letter, DA Form 2028, or DA Form 2028-2 direct to: Commander, U.S. Army Tank-automotive and Armaments Command, ATTN: AMSTA-AC-NML, Rock Island, IL 61299-7630. The e-mail address is amsta-ac-nml@ria.army.mil. The fax number is DSN 793-0726 or Commercial (309) 782-0726.

APPROVED FOR PUBLIC RELEASE; DISTRIBUTION IS UNLIMITED

This manual is published in two volumes.

TABLE OF CONTENTS

	Page	Illus. Figure
Section I INTRODUCTION	1	
Section II REPAIR PARTS LIST	1-1	
Group 01 Engine		
0100 Engine mounting	1-1	1
0100 Engine assembly	2-1	2
0101 Engine block	3-1	3
0101 Engine end plates	4-1	4

*This Manual in Conjunction with TM 9-2320-279-24P-2 supersedes TM 2320-279-20P, TM 9-2320-279-34P-1, TM 9-2320-279-34P-2, and Appendix B of TM 9-2815-224-34&P in their entirety.

	Page	Illus. Figure
0101 Air box covers and drains	5-1	5
0101 Cylinder head	6-1	6
0102 Crankshaft	7-1	7
0102 Crankshaft cover, trunnion, and oil seal	8-1	8
0103 Flexplate and flywheel housing assembly	9-1	9
0104 Piston and connecting rod	10-1	10
0105 Rocker cover	11-1	11
0105 Valves, rocker arms, and cam followers	12-1	12
0105 Camshafts	13-1	13
0105 Idler gear	14-1	14
0105 Vibration damper and front valance cover	15-1	15
0106 Breather tubes and hoses	16-1	16
0106 Oil filter	17-1	17
0106 Oil cooler	18-1	18
0106 Oil pan and dipstick	19-1	19
0106 Oil pump mounting	20-1	20
0106 Oil pump assembly	21-1	21
0106 Oil pressure relief valve	22-1	22
0106 Oil pressure regulator	23-1	23
0108 Exhaust manifold	24-1	24
0109 Blower drive	25-1	25
0109 Water pump drive	26-1	26
0112 Engine brake retarder	27-1	27
0112 Retarder buffer switch assembly	28-1	28
Group 03 Fuel system		
0301 Fuel injector	29-1	29
0301 Fuel injector control tube	30-1	30
0302 Fuel pump	31-1	31
0304 Air restriction indicator	32-1	32
0304 Air cleaner assembly	33-1	33
0304 Air intake ducting	34-1	34
0305 Blower assembly	35-1	35
0305 Turbocharger mounting	36-1	36
0305 Turbocharger mounting	37-1	37
0305 Turbocharger assembly	38-1	38
0306 Fuel tank assembly	39-1	39
0306 Fuel lines and fittings	40-1	40
0306 Engine fuel lines and fittings	41-1	41
0308 Governor mounting	42-1	42
0308 Governor assembly	43-1	43
0308 Governor cover	44-1	44
0308 Governor weights assembly	45-1	45
0308 Variable low speed limiting governor	46-1	46
0308 Throttle stop (shutdown) control	47-1	47
0308 Throttle delay	48-1	48
0308 Fuel modulator	49-1	49
0308 Throttle air cylinder	50-1	50
0309 Secondary fuel filter	51-1	51
0309 Fuel/water separator	52-1	52
0311 Ether starting aid	53-1	53
0312 Throttle treadle valve	54-1	54

	Page	Illus. Figure
	0312 Throttle control lines and fittings	55-1 55
	0312 Throttle control lines and fittings - M984	56-1 56
Group 04	Exhaust system	
	0401 Muffler and pipes	57-1 57
Group 05	Cooling system	
	0501 Radiator assembly	58-1 58
	0502 Radiator mounting	59-1 59
	0503 Cooling hoses, lines and fittings	60-1 60
	0503 Thermostat and lines	61-1 61
	0503 Aftercooler	62-1 62
	0504 Water pump assembly	63-1 63
	0505 Fan and fan clutch mounting	64-1 64
	0505 Fan clutch assembly	65-1 65
Group 06	Electrical system	
	0601 Alternator mounting	66-1 66
	0601 Alternator assembly	67-1 67
	0601 Alternator assembly	67A-1 67A
	0603 Starter motor mounting	68-1 68
	0603 Starter motor assembly	69-1 69
	0606 Engine safety controls	70-1 70
	0606 High idle box - M977 and M985	71-1 71
	0606 High idle box (front) - M984 and M985E1	72-1 72
	0606 High idle box (rear) - M984 and M985E1	73-1 73
	0607 Instrument control panel	74-1 74
	0607 Instrument control panel wiring	75-1 75
	0607 Engine control switches	76-1 76
	0607 Side control panel	77-1 77
	0607 Circuit breaker panel	78-1 78
	0607 Heater control switch	79-1 79
	0607 Utility outlet	80-1 80
	0608 Main and auxiliary junction boxes - M978	81-1 81
	0608 Control junction box - M978	82-1 82
	0608 Module conduit installation - M978	83-1 83
	0608 Tank conduit installation - M978	84-1 84
	0608 Crane electrical - M977 and M985	85-1 85
	0608 Crane electrical - M984A1	86-1 86
	0608 Control box - M984A1	87-1 87
	0608 Turn signal switch and flasher	88-1 88
	0609 Head lamp assembly	89-1 89
	0609 Front composite light	90-1 90
	0609 Composite taillight	91-1 91
	0609 Blackout lamp	92-1 92
	0609 Front cab clearance light	93-1 93
	0609 Clearance marker lights	94-1 94
	0609 Red and amber marker lights - M978	95-1 95
	0609 Pump module clearance lights - M978	96-1 96
	0609 Worklamp mounting - M983	97-1 97
	0609 Worklamp mounting - M984	98-1 98
	0609 Fixed worklamp - M983 and M984	99-1 99
	0609 Removable worklamp - M983 and M984	100-1 100
	0609 Fixed worklamp - M984A1	101-1 101

	Page	Illus. Figure
0609 Removable worklamp - M984A1	102-1	102
0609 Removable warning light - M984 and M984A1	103-1	103
0609 Removable warning light - M984A1	104-1	104
0609 Removable warning light - M984A1	104A-1	104A
0609 Strobe light installation - M984A1	105-1	105
0609 Strobe light assembly - M984A1	106-1	106
0609 Strobe light assembly - M984A1	107-1	107
0609 Strobe light assembly - M984A1	107A-1	107A
0609 Tow light assembly - M984A1	108-1	108
0609 Optic ribbon installation	109-1	109
0609 Dome light	110-1	110
0609 Pump module compartment light - M978	111-1	111
0610 Fuel level sending unit	112-1	112
0610 Sending units and warning switches	113-1	113
0610 Tank level indicator installation - M978	114-1	114
0611 Electric horn	115-1	115
0612 Battery box assembly	116-1	116
0612 Battery installation	117-1	117
0613 NATO connector	118-1	118
0613 Engine wiring installation	119-1	119
0613 Engine wiring harness	120-1	120
0613 Cab wiring installation	121-1	121
0613 Cab wiring harness	122-1	122
0613 Chassis wiring installation - M977 and M985	123-1	123
0613 Chassis wiring harness - M977 and M985	124-1	124
0613 Chassis wiring installation - M984	125-1	125
0613 Chassis wiring harness - M984	126-1	126
0613 Chassis wiring installation - M983	127-1	127
0613 Chassis wiring harness - M983	128-1	128
0613 Chassis wiring installation - M978	129-1	129
0613 Chassis wiring harness - M978	130-1	130
0613 Chassis wiring installation - M985E1	131-1	131
0613 Chassis wiring harness - M985E1	132-1	132
0613 Chassis wiring installation - M984A1	133-1	133
0613 Chassis wiring harness - M984A1	134-1	134
0613 Tanker wiring - M978	135-1	135
0613 Module wiring - M978	136-1	136
0613 Intervehicle harness	137-1	137
0613 Intervehicle harness - M983	138-1	138
0613 Tow light cable	139-1	139
0613 STE/ICE components and wiring	140-1	140
Group 07 Transmission		
0705 Transmission shift cable	141-1	141
0705 Transmission shift tower	142-1	142
0708 Torque converter, lockup clutch and flywheel	143-1	143
0710 Transmission mounting	144-1	144
0710 Transmission housing, oil filter and oil pan	145-1	145
0710 Front support assembly	146-1	146
0710 Input shaft and forward clutch	147-1	147
0710 Gear unit and main shaft	148-1	148
0710 Rear cover assembly	149-1	149

	Page	Illus. Figure	
0710	First and reverse clutch	150-1	150
0713	Fourth clutch assembly	151-1	151
0713	Second clutch, center support and third clutch	152-1	152
0714	Control valve assembly	153-1	153
0714	Lock-up cutoff valve assembly	154-1	154
0714	Governor assembly	155-1	155
0721	Transmission hoses, fittings and solenoid valve	156-1	156
0721	Oil pump assembly	157-1	157
0721	Transmission oil filter	158-1	158
Group 08	Transfer case		
0801	Transfer case mounting	159-1	159
0801	Transfer case assembly	160-1	160
0803	HI-LO range lock-up valve	161-1	161
0803	Traction control valve	162-1	162
0803	Lockout shift chamber	163-1	163
0803	Transfer case shift installation	164-1	164
0804	Transfer case lubrication lines and fittings	165-1	165
0804	Transfer case lubrication pump	166-1	166
Group 09	Propeller shafts		
0900	Transmission to transfer case propeller shaft	167-1	167
0900	Rear inter-axle propeller shaft	168-1	168
0900	Rear inter-axle propeller shaft - M984	169-1	169
0900	Rear inter-axle propeller shaft - M984A1	170-1	170
0900	Transfer case to No. 3 axle propeller shaft	171-1	171
0900	Transfer case to No. 3 axle propeller shaft - M983	172-1	172
0900	Transfer case to No. 3 axle propeller shaft - M984	173-1	173
0900	Transfer case to No. 3 axle propeller shaft - M984A1	174-1	174
0900	Transfer case to No. 2 axle propeller shaft	175-1	175
0900	Front inter-axle propeller shaft	176-1	176
Group 10	Front axle		
1000	No. 1 front axle assembly	177-1	177
1000	No. 2 front axle assembly	178-1	178
1002	No. 1 differential carrier assembly	179-1	179
1002	No. 2 differential carrier assembly	180-1	180
1004	Front ball sockets and steering arms	181-1	181
Group 11	Rear axle		
1100	No. 3 axle assembly	182-1	182
1100	No. 4 axle assembly	183-1	183
1102	No. 3 differential carrier assembly	184-1	184
1102	No. 4 differential carrier assembly	185-1	185
1102	No. 3 differential carrier assembly - M984 and M984A1	186-1	186
1102	No. 4 differential carrier assembly - M984 and M984A1	187-1	187
Group 12	Brakes		
1202	Front brake assembly	188-1	188
1202	Rear brake assembly	189-1	189
1208	Front brake chamber assembly	190-1	190
1208	Rear brake chamber assembly	191-1	191
1208	Brake treadle valve	192-1	192
1208	Cab air lines and fittings	193-1	193
1208	Chassis air tanks, lines and fittings	194-1	194
1208	Chassis air tanks, lines, and fittings - M983	195-1	195

	Page	Illus. Figure
1208 Chassis air tanks, lines, and fittings - M984A1	196-1	196
1208 Relay valve	197-1	197
1208 Relay valve	197A-1	197A
1208 Spring brake valve	198-1	198
1208 Parking brake valve	199-1	199
1208 Front check valves	200-1	200
1208 Front quick release valves	200A-1	200A
1208 Rear check valve	201-1	201
1208 Air dryer	202-1	202
1208 Air dryer cartridge	203-1	203
1208 Air dryer cover	204-1	204
1209 Air compressor installation	205-1	205
1209 Air compressor assembly	206-1	206
1211 Trailer brake hand control valve	207-1	207
1211 Trailer supply valve	208-1	208
1211 Tractor protection valve	209-1	209
1211 Trailer brake connections	210-1	210
Group 13 Wheels		
1311 Wheel and tire assembly	211-1	211
1311 Wheel and tire assembly	211A-1	211A
1311 Front hub and drum assembly	212-1	212
1311 Rear hub and drum assembly	213-1	213
1311 Rear hub and drum assembly - M984 and M984A1	214-1	214
Group 14 Steering		
1401 Steering wheel and column	215-1	215
1401 Steering shafts and gearbox mounting	216-1	216
1401 Steering shafts assembly	217-1	217
1401 90° gearbox assembly	218-1	218
1401 Steering linkage	219-1	219
1407 Slave steering gear assembly	220-1	220
1407 Steering gear assembly	221-1	221
1410 Steering pump	222-1	222
1410 Steering tensioner pump - M984A1	223-1	223
1411 Steering hydraulic lines and fittings	224-1	224
1411 Steering hydraulic lines and fittings - M984A1	225-1	225
1413 Hydraulic reservoir assembly	226-1	226
1413 Hydraulic reservoir assembly - M984A1	227-1	227
1413 Main hydraulic filter	228-1	228
1413 Main hydraulic filter - M984A1	229-1	229
1414 Tensioner valve - M984A1	230-1	230
Group 15 Frame and towing attachments		
1501 Frame assembly - M977, M985 and M985E1	231-1	231
1501 Frame assembly - M978	232-1	232
1501 Frame assembly - M983	233-1	233
1501 Frame assembly - M984	234-1	234
1501 Frame assembly - M984A1	235-1	235
1501 Skid plate	236-1	236
1501 Fifth wheel ramp - M983	237-1	237
1503 Pintle hitch assembly	238-1	238
1503 Self guided coupler	239-1	239
1503 Tow bar - M984	240-1	240
1503 Retriever installation - M984A1	241-1	241

	Page	Illus. Figure
1503 Retriever lift cylinder assembly - M984A1	242-1	242
1503 Retriever lift cylinder assembly - M984A1	242A-1	242A
1503 Retriever tow cylinder assembly M984A1	243-1	243
1503 Retriever tow cylinder assembly - M984A1	243A-1	243A
1503 Towing attachments - M984A1	244-1	244
1504 Tire carrier and davit	245-1	245
1504 Tire carrier winch	246-1	246
1504 Trailer tire carrier - M983	247-1	247
1506 Fifth wheel - 3.5 inch king pin - M983	248-1	248
Group 16 Springs and shock absorbers		
1601 Front spring and saddle	249-1	249
1601 Rear spring and saddle	250-1	250
1604 Shock absorbers	251-1	251
1605 Front torque rods	252-1	252
1605 Rear torque rods	253-1	253
1605 Front equalizer beams	254-1	254
1605 Rear equalizer beams	255-1	255
Group 18 Cab and body		
1801 Cab assembly	256-1	256
1801 Cab insulation	257-1	257
1801 Door assembly	258-1	258
1801 Engine covers	259-1	259
1802 Cab glass installation	260-1	260
1802 Right front fender, splash guards and mudflaps	261-1	261
1802 Left front fender, splash guards and mudflaps	262-1	262
1802 Rear fender and splash guards - M977 and M985	263-1	263
1802 Right rear fender and splash guards - M984	264-1	264
1802 Left rear fender and splash guards - M984	265-1	265
1802 Splash guards - M978	266-1	266
1802 Splash guards - M985E1	267-1	267
1802 Quarter fender - M983	268-1	268
1802 Rear fenders and splash guards - M984A1	269-1	269
1806 Seat assembly and sun visor	270-1	270
1808 Front stowage box assembly	271-1	271
1808 Front stowage box - M984A1	272-1	272
1808 Wheel chock stowage box	273-1	273
1808 Rear stowage box - M977, M984, M985, and M985E1	274-1	274
1808 Rear stowage box - M977, M978 and M985	275-1	275
1808 Chain sling stowage box	276-1	276
1808 Fuel can stowage box - M978	277-1	277
1808 Left cargo body stowage boxes - M984A1	278-1	278
1808 Right cargo body stowage boxes - M984A1	279-1	279
1808 Fire extinguisher stowage brackets	280-1	280
1808 Vise mounting - M984A1	281-1	281
1808 Static ground reel - M978	282-1	282
1808 Fuel hose reel - M978	283-1	283
1808 Air hose reel - M978	284-1	284
1810 Cargo body and mounting - M977, M985, and M985E1	285-1	285
1811 Tanker body and mounting - M978	286-1	286
1811 Tanker module and mounting - M978	287-1	287
1811 Hose reel roller assembly - M978	288-1	288

	Page	Illus. Figure
1811 Door piston assembly - M978	289-1	289
1812 Wrecker body and mounting - M984	290-1	290
1812 Wrecker body and mounting - M984A1	291-1	291
Group 20 Winches, cranes, and power takeoff		
2001 Self recovery winch mounting	292-1	292
2001 Self recovery winch assembly	293-1	293
2001 Self recovery winch motor	294-1	294
2001 Self recovery winch counterbalance valve	295-1	295
2001 Self recovery winch brake	296-1	296
2001 Front cable tensioner	297-1	297
2001 Front cable guide	298-1	298
2001 Rear cable tensioner	299-1	299
2001 Rear cable guide	300-1	300
2001 Small rear cable guide	301-1	301
2001 Heavy duty winch mounting - M984	302-1	302
2001 Heavy duty winch assembly - M984	303-1	303
2001 Heavy duty winch motor - M984	304-1	304
2001 Heavy duty winch counterbalance valve - M984	305-1	305
2001 Heavy duty winch brake - M984	306-1	306
2001 Heavy duty winch remote control - M984	307-1	307
2001 Heavy duty winch mounting - M984A1	308-1	308
2001 Heavy duty winch assembly - M984A1	309-1	309
2001 Heavy duty winch motor - M984A1	310-1	310
2001 Heavy duty winch motor - M984A1	311-1	311
2001 Heavy duty winch counterbalance valve - M984A1	312-1	312
2001 Heavy duty winch brake - M984A1	313-1	313
2001 Heavy duty winch fairlead motor - M984A1	314-1	314
2001 Heavy duty winch motor	314A-1	314A
2001 Heavy duty winch remote control and cable - M984A1	315-1	315
2001 Crane assembly and mounting - M977 and M985	316-1	316
2001 Crane assembly and mounting - M984A1	317-1	317
2001 Turntable assembly - M977 and M985	318-1	318
2001 Turntable assembly - M984A1	319-1	319
2001 Swing drive assembly - M977, M984A1 and M985	320-1	320
2001 Swing drive motor assembly - M977, M984A1 and M985	321-1	321
2001 Swing drive gear reducer assembly - M977	322-1	322
2001 Swing drive gear reducer assembly - M984A1 and M985	323-1	323
2001 Crane boom and mast - M977, M984A1 and M985	324-1	324
2001 Crane hydraulic lines and fittings - M977 and M985	325-1	325
2001 Crane hydraulic lines and fittings - M984A1	326-1	326
2001 Erection cylinder - M977 and M985	327-1	327
2001 Erection cylinder - M984A1	328-1	328
2001 Lift cylinder assembly - M977, M984A1 and M985	329-1	329
2001 Extension cylinder assembly - M977, M984A1 and M985	330-1	330
2001 Tension link assembly - M984A1	331-1	331
2001 Hoist cable follower and guide - M977, M985	332-1	332
2001 Crane hoist mounting - M977, M984A1 and M985	333-1	333
2001 Crane hoist assembly - M984A1	334-1	334
2001 Crane hoist assembly - M977, M985	335-1	335
2001 Crane hoist carrier assembly (secondary) - M977, M984A1 and M985	336-1	336

	Page	Illus. Figure
2001 Crane hoist carrier assembly (primary) - M977, M984A1 and M985	337-1	337
2001 Crane hoist motor assembly - M977, M984A1 and M985	338-1	338
2001 Crane hoist brake assembly - M977, M984A1 and M985	339-1	339
2001 Crane hook assembly - M977	340-1	340
2001 Crane hook block assembly - M984A1 and M985	341-1	341
2001 Stowage hook guide assembly - M984A1	342-1	342
2001 Crane control valve mounting - M977 and M985	343-1	343
2001 Crane control valve assembly - M977 and M985	344-1	344
2001 Crane control valve mounting - M984A1	345-1	345
2001 Crane control valve, right front - M984A1	346-1	346
2001 Crane control valve, right Rear - M984A1	347-1	347
2001 Crane control valve assembly, left - M984A1	348-1	348
2001 Crane swing control valve - M977 and M985	349-1	349
2001 Crane swing control valve - M984A1	350-1	350
2001 Crane telescope control valve - M977 and M985	351-1	351
2001 Crane telescope control valve - M984A1	352-1	352
2001 Crane boom control valve - M977 and M985	353-1	353
2001 Crane boom control valve - M984A1	354-1	354
2001 Crane hoist control valve - M977 and M985	355-1	355
2001 Crane hoist control valve - M984A1	356-1	356
2001 Crane mast and outrigger extension control valve - M977, M984A1 and M985	357-1	357
2001 Crane outrigger extension control valve - M984A1	358-1	358
2001 Outrigger control valve, LH - M977, M984A1 and M985	359-1	359
2001 Outrigger control valve, RH - M977, M984A1 and M985	360-1	360
2001 Crane accumulator assembly - M977, M984A1 and M985	361-1	361
2001 Crane accumulator assembly - M977, M984A1 and M985	361A-1	361A
2001 Solenoid valve assembly - M977, M984A1 and M985	362-1	362
2001 Relief valve - M984A1	363-1	363
2001 Crane remote control assembly - M977, M984A1 and M985	364-1	364
2001 Crane remote control cable assembly - M977, M984A1 and M985	365-1	365
2001 Front control cable - M977 and M985	366-1	366
2001 Crane mounting - M984	367-1	367
2001 Crane mounting - M985E1	368-1	368
2004 Power takeoff installation	369-1	369
2004 Power takeoff assembly	370-1	370
2004 Power takeoff hydraulic pump assembly	371-1	371
2004 Power takeoff installation - M984A1	372-1	372
2004 Power takeoff assembly - M984A1	373-1	373
2004 Power takeoff hydraulic pump assembly - M984A1	374-1	374
2005 Tow spade assembly	375-1	375
2006 Outrigger assembly - M977 and M985	376-1	376
2006 Outrigger hydraulic lines and fittings - M977	377-1	377
2006 Outrigger hydraulic lines and fittings - M985	378-1	378
2006 Outrigger leg cylinder - M977 and M985	379-1	379
2006 Outrigger extension cylinder - M977 and M985	380-1	380
2006 Outrigger assembly - M984A1	381-1	381
2006 Outrigger hydraulic lines and fitting - M984A1	382-1	382

	Page	Illus. Figure	
2006	Outrigger leg cylinder - M984A1	383-1	383
2006	Outrigger extension cylinder - M984A1	384-1	384
2006	Outrigger pad assembly - M977, M984A1 and M985	385-1	385
Group 22	Accessory items		
2201	Cargo cover kit	386-1	386
2202	Windshield wiper installation	387-1	387
2202	Wiper control valve	388-1	388
2202	Windshield washer installation	389-1	389
2202	Windshield washer bottle	390-1	390
2202	Air horn and valve	391-1	391
2202	Mirror assembly	392-1	392
2202	Mirror assembly	392A-1	392A
2202	Extension mirror assembly - M984A1	393-1	393
2202	Reflectors	394-1	394
2202	Fuel transfer hose - M978	395-1	395
2202	Fuel transfer hose - M978	396-1	396
2202	Fuel nozzle assembly - M978	397-1	397
2202	Air hose and HAV valve - M978	398-1	398
2207	Heater installation	399-1	399
2207	Heater assembly	400-1	400
2210	Data plates	401-1	401
Group 24	Hydraulic system		
2402	Main hydraulic relief valve	402-1	402
2402	Pressure relief valve - M983	403-1	403
2402	Self recovery winch control valve mounting	404-1	404
2402	Self recovery winch control valve assembly	405-1	405
2402	Priority flow valve - M978 and M984	406-1	406
2402	Self recovery winch selector valve	407-1	407
2402	Heavy duty winch selector valve - M984	408-1	408
2402	Primary pump hydraulic motor control valve mounting - M978	409-1	409
2402	Heavy duty winch manifold - M984A1	410-1	410
2402	Retriever control valve - M984A1	411-1	411
2406	Crane hydraulic filter - M977, M984A1 and M985	412-1	412
2406	Crane hydraulic filter - M977, M984A1 and M985	412A-1	412A
2406	Hydraulic lines and fittings - M977 and M985 with winch	413-1	413
2406	Hydraulic lines and fittings - M977 and M985 without winch	414-1	414
2406	Hydraulic lines and fittings - M978 with winch	415-1	415
2406	Hydraulic lines and fittings - M978 without winch	416-1	416
2406	Hydraulic lines and fittings - M983 without crane	417-1	417
2406	Hydraulic lines and fittings - M984	418-1	418
2406	Hydraulic lines and fittings - M985E1 with winch	419-1	419
2406	Hydraulic lines and fittings - M984A1	420-1	420
Group 33	Special purpose kits		
3301	Engine shipping container	421-1	421
3301	Transmission shipping container	422-1	422
3301	Transfer case shipping container	423-1	423
3303	Arctic heater kit	424-1	424
3303	Arctic kit electrical wiring installation	425-1	425
3303	Arctic battery box assembly	426-1	426

	Page	Illus. Figure
3303 Arctic battery installation	427-1	427
3303 Arctic kit grille	428-1	428
3303 Arctic kit water jackets	429-1	429
3303 Arctic kit water pump mounting	430-1	430
3303 Arctic kit water pump	431-1	431
Group 34 Armament		
3401 Machine gun operator's platform	432-1	432
3401 Machine gun ring	433-1	433
3401 Rifle mounting	434-1	434
Group 47 Gages (non-electrical)		
4702 Air pressure gage	435-1	435
4702 Pressure gage installation - M978	436-1	436
Group 56 Filter-separator		
5600 Filter-separator installation - M978	437-1	437
5600 Filter-separator assembly - M978	438-1	438
5600 Filter-separator assembly - M978	439-1	439
Group 68 Radio		
6809 Radio installation	440-1	440
Group 72 Dispensing and servicing components - M978		
7202 Primary pump installation	441-1	441
7202 Primary pump assembly	442-1	442
7202 Hydraulic motor	443-1	443
7202 Auxiliary pump	444-1	444
7202 Flowmeter installation	445-1	445
7202 Flowmeter assembly	446-1	446
7202 Air eliminator	447-1	447
7202 Flowmeter strainer	448-1	448
7203 Module piping installation	449-1	449
7203 Tank piping installation	450-1	450
7203 V3 suction line valve/V17 gravity valve	451-1	451
7203 V1 emergency valve installation	452-1	452
7203 V1 emergency valve assembly	453-1	453
7203 V1 emergency valve actuator assembly	454-1	454
7203 V10 bottom load installation	455-1	455
7203 V10 bottom load valve assembly	456-1	456
7203 V14 pilot valve	457-1	457
7203 V13 vent valve	458-1	458
7203 V19 jet level sensor installation	459-1	459
7203 V19 jet level sensor assembly	460-1	460
7203 Venturi	461-1	461
7203 V18 bulk delivery valve	462-1	462
7203 V12 Bottom load precheck valve/sampling probe valve	463-1	463
7203 V2 Bottom load adapter	464-1	464
7203 V7/V8 reel valve	465-1	465
7203 V9/V16 check valve	466-1	466
7203 V5 air actuated flow valve	467-1	467
7203 V6 fuel/defuel valve	468-1	468
7203 V11 row regulating valve	469-1	469
7203 V4 relief valve	470-1	470
Group 91 Chemical, biological, and radiological (CBR) equipment		
9111 Gas particulate filter unit installation	471-1	471

	Page	Illus. Figure
9120 M13 decontamination unit installation	472-1	472
9131 M8 chemical alarm installation	473-1	473
Group 94 9401 Repair kits	Kits-1	
Group 95 9501 Bulk materials	Bulk-1	
Section III SPECIAL TOOLS LIST		
2604 Organizational special tools	474-1	474
2604 Direct support special tools	475-1	475
2604 General support special tools	476-1	476
Section IV CROSS-REFERENCE INDEX		
National stock number index	I-1	
Part number index	I-129	
Figure and item number index	I-457	

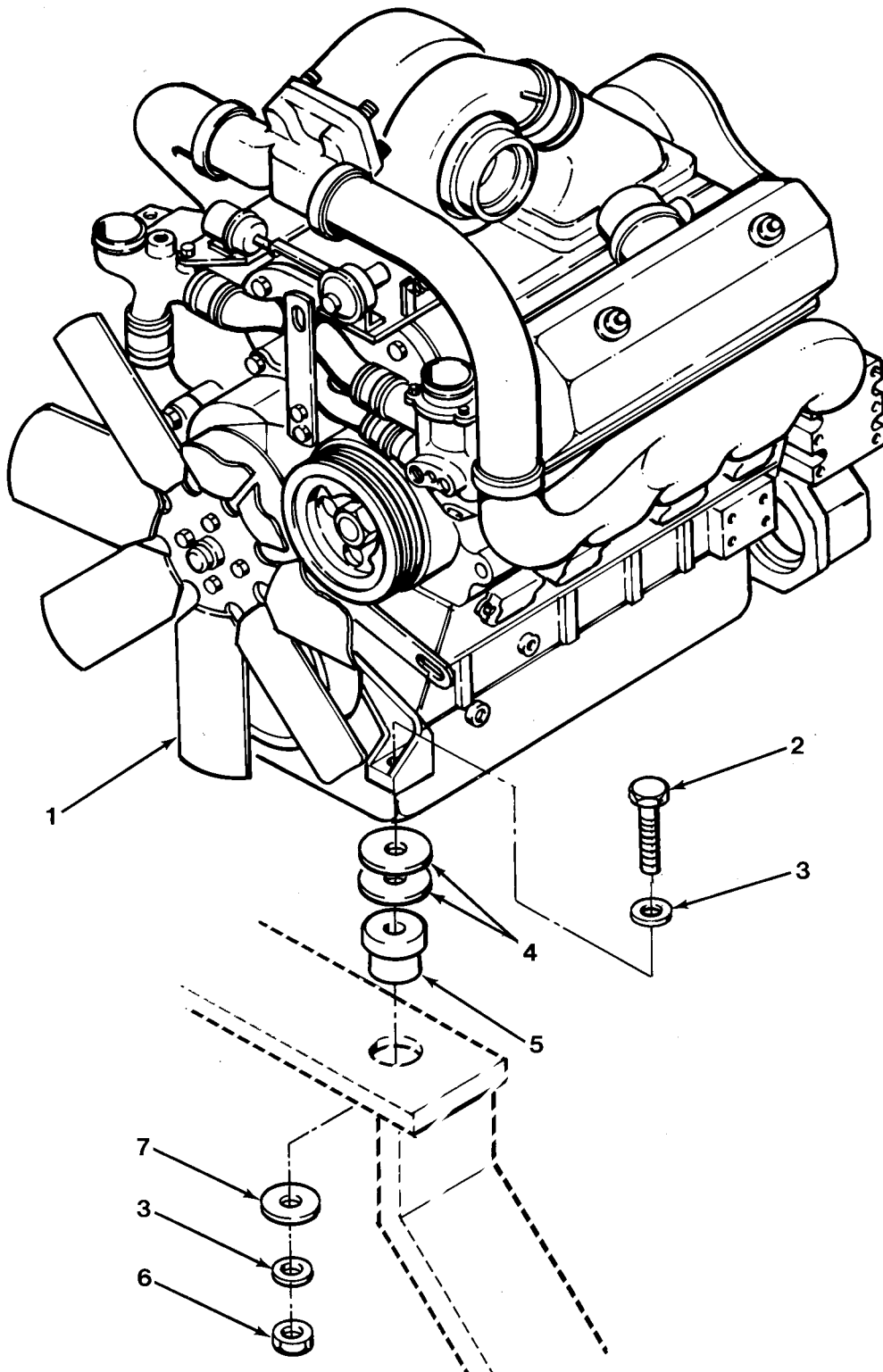

FIG.1 ENGINE MOUNTING

SECTION II

TM 9-2320-279-24P

(1) ITEM NO	(2) SMR CODE	(3) CAGEC CAGEC	(4) PART NUMBER	(5) DESCRIPTION AND USABLE ON CODES(UOC)	(6) QTY
				GROUP 01 ENGINE	
				GROUP 0100 ENGINE ASSEMBLY	
				FIG.1 ENGINE MOUNTING	
1	PAFHH	19207	5705718	ENGINE AND CONTAINERS	1
2	PAFZZ	80204	B1821BH063C450N	SCREW,CAP,HEXAGON H	2
3	PAFZZ	45152	8865GX	WASHER,FLAT	4
4	PAFZZ	45152	104492A	WASHER,FLAT	4
5	PAFZZ	38460	504-1126	BUSHING,NONMETALLIC	2
6	PAFZZ	OKS39	TLA-5811-S-GRC	NUT,SELF-LOCKING,CO	2
7	PAFZZ	45152	7953GX	WASHER,FLAT	2

END OF FIGURE