

TECHNICAL MANUAL

OPERATORS, ORGANIZATIONAL, AND DIRECT SUPPORT
MAINTENANCE MANUAL AND REPAIR PARTS AND
SPECIAL TOOLS LIST

This copy is a reprint which includes current pages from changes 1 through 5.

CLOSED CIRCUIT REFUELING NOZZLE

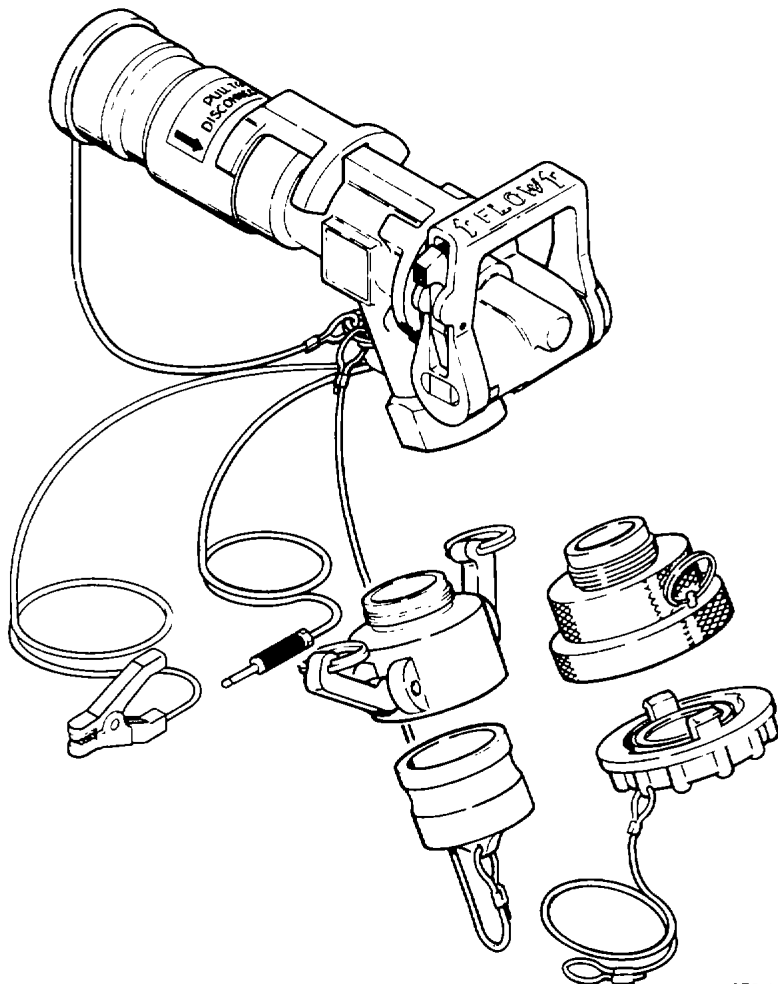

INTRODUCTION

OPERATING INSTRUCTIONS

OPERATOR MAINTENANCE INSTRUCTIONS

ORGANIZATIONAL MAINTENANCE INSTRUCTIONS

DIRECT SUPPORT MAINTENANCE INSTRUCTIONS

REFERENCES

MAINTENANCE ALLOCATION CHART

COMPONENT OF END ITEM/BASIC ISSUE ITEMS

ADDITIONAL AUTHORIZATION LIST

EXPENDABLE/DURABLE SUPPLIES AND MATERIALS LIST

REPAIR PARTS AND SPECIAL TOOLS LIST

INDEX

MODEL NUMBERS

NSN 4930-01-194-2625 (AE83206R)

NSN 4930-01-214-2909 (AE83501R)

**Operator's, Organizational, and Direct Support Maintenance Manual
and Repair Parts and Special Tools List
CLOSED CIRCUIT REFUELING NOZZLE
MODEL NUMBERS
NSN 4930-01-194-2625 (AE83206R)
NSN 4930-01-214-2909 (AE83501 R)**

REPORTING ERRORS AND RECOMMENDING IMPROVEMENTS

You can help improve this manual. If you find any mistakes, or if you know of a way to improve these procedures, please let us know. Mail your letter, DA Form 2028 (Recommended Changes to Publications and Blank Forms) or DA Form 2028-2 located in the back of this manual directly to: Commander, US Army Aviation and Troop Command, ATTN: AMSAT-I-MP, 4300 Goodfellow Blvd., St. Louis, MO 63120-1798. You may also submit your recommended changes by E-mail directly to <mpmt%/oavma28@st-louis-emh7.army.mil>. A reply will be furnished directly to you. Instructions for sending an electronic 2028 may be found at the back of this manual immediately preceding the hard copy 2028.

DISTRIBUTION STATEMENT A: Approved for public release; distribution is unlimited

TABLE OF CONTENTS

	PAGE
CHAPTER 2 INTRODUCTION	1-1
Section IV General Information	1-1
Section V Equipment Description and Data	1-1
Section VI Principles of Operation	1-3
CHAPTER 3 OPERATING INSTRUCTIONS	3-1
Section I Description and Use of Operator's Controls and Indicators.....	2-1
Section II Operator Preventive Maintenance Checks and Services	2-2
Section III Operation Under Usual Conditions	2-3
Section IV Operation Under Unusual Conditions	2-9
CHAPTER 4 OPERATOR MAINTENANCE INSTRUCTIONS	4-1
Section I Lubrication Instructions	3-1
Section II Troubleshooting Procedures.....	3-1
Section III Maintenance Procedures.....	3-2
CHAPTER 5 ORGANIZATIONAL MAINTENANCE INSTRUCTIONS.....	5-1
Section I Repair Parts, Special Tools; Test, Measurement, and Diagnostic Equipment (TMDE); and Support Equipment	4-1
Section II Service Upon Receipt	4-1
Section III Troubleshooting Procedures.....	4-1
Section IV Maintenance Procedures.....	4-4
Section V Preparation for Storage or Shipment	4-13
CHAPTER 6 DIRECT SUPPORT MAINTENANCE INSTRUCTIONS.....	6-1
Section I Troubleshooting Procedures.....	5-1
Section II Maintenance Procedures.....	5-5

Table of Contents (Continued)

	Page
APPENDIX A. REFERENCES	A-1
APPENDIX B. MAINTENANCE ALLOCATION CHART	B-1
APPENDIX C. COMPONENTS OF END ITEM/BASIC ISSUE ITEMS	C-1
APPENDIX D. ADDITIONAL AUTHORIZATION LIST	D-1
APPENDIX E. EXPENDABLE/DURABLE SUPPLIES AND MATERIALS LIST.....	E-1
APPENDIX F. REPAIR PARTS AND SPECIAL TOOLS LIST.....	F-1
INDEX.....	AI-1

LIST OF ILLUSTRATIONS

Figure	Title	Page
1-1	CCR Nozzle Assembly	1-0
2-1	Operating Controls	2-0
2-2.	Operation of Nozzle, Model AE83206R.....	2-4
2-3	Operation of Nozzle, Model AE835 01R.....	2-7
3-1	Cam-Lock Gasket Replacement	3-3
3-2	Unisex Seal Replacement	3-4
3-3	Strainer and O-ring Replacement.....	3-5
4-1	Dust Cap Assembly.....	4-4
4-2	Dust Plug Assembly	4-6
4-3	Ground Plug Assembly.....	4-8
4-4	Ground Clip Assembly.....	4-9
4-5	Cam-Lock Coupling Assembly	4-11
4-6	Unisex Coupling Assembly.....	4-12
5-1	Cam-Lock Coupling Removal	5-6
5-2	Cam Arm Disassembly.....	5-7
5-3	Cam Arm Assembly	5-7
5-4	Unisex Coupling Removal	5-8
5-5	Unisex Coupling Disassembly.....	5-9
5-6	CCR Nozzle Component Removal.....	5-11
5-7	CCR Nozzle Disassembly	5-13
5-8	Plunger Removal.....	5-14
5-9	Nose Sleeve Removal.....	5-16
5-10	Adapter Removal.....	5-16
5-11	Adapter Assembly	5-19
5-12	Removal of Release Pin Mechanism Tool	5-20
5-13	Body Installation	5-21
5-14	Tool Installation	5-21

LIST OF ILLUSTRATIONS (Continued)

Figure	Title	Page
5-15	Adapter Installation	5-22
5-16	Torquing Nose Sleeve	5-22
5-17	Piston and Rack Assembly	5-23
5-18	Handle and Thumb Latch Assembly	5-23
5-19	Plunger Assembly	5-24
5-20	Rack Positioning Tool	5-26
5-21	Pin Positioning Tool	5-26
5-22	Pinion Assembly	5-26
5-23	Ring Assembly	5-26
5-24	Deleted	■

LIST OF TABLES

Table	Title	Page
2-1	Operator Preventive Maintenance Checks and Services	2-3
3-1	Troubleshooting (Operator)	3-1
4-1	Troubleshooting (Organizational)	4-2
5-1	Troubleshooting (Direct Support)	5-1
5-2	Spring Dimensions	5-18

Change 4 iii/(iv blank)

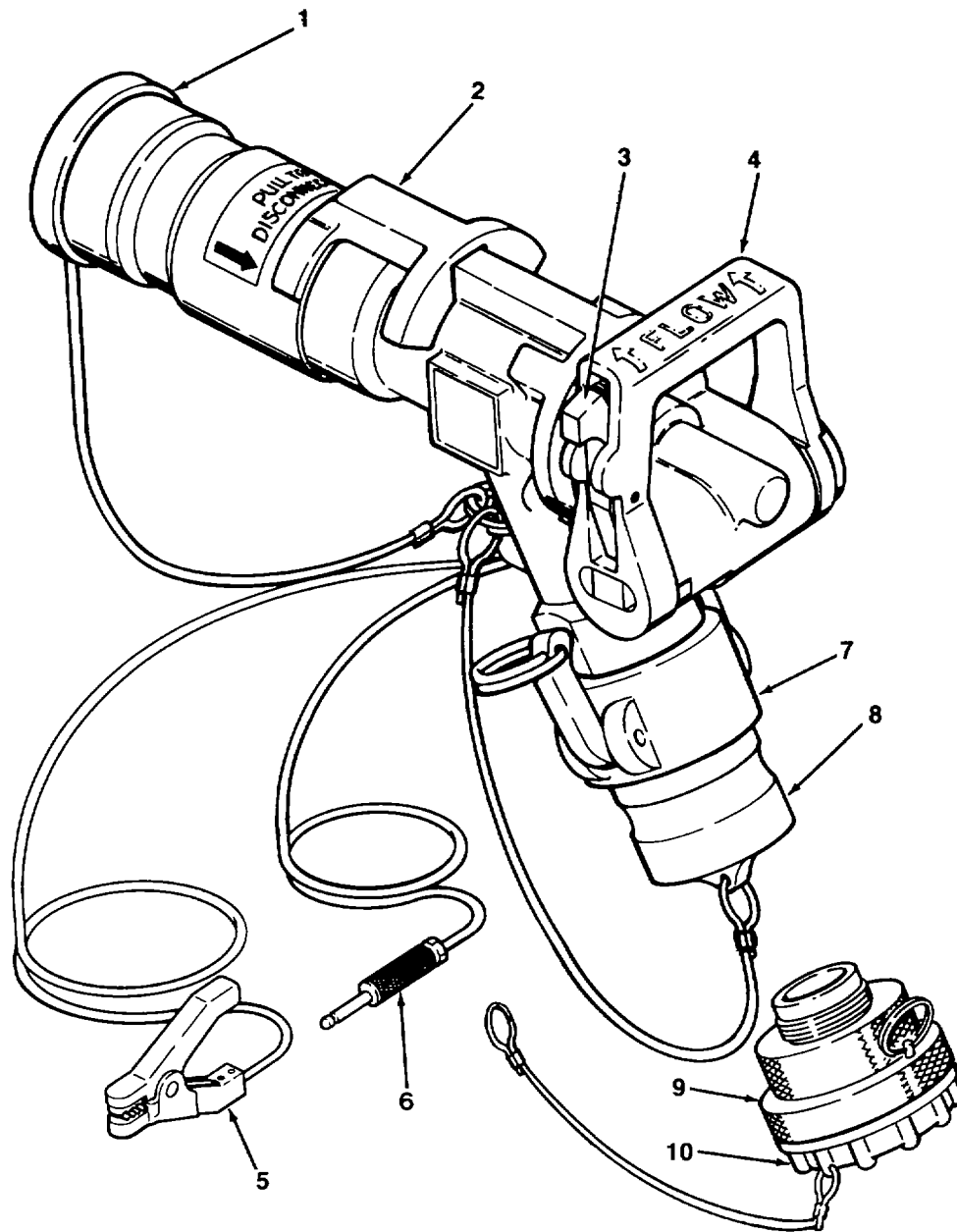

12536A

- 1. DUST CAP
- 2. PULLBACK SLEEVE
- 3. THUMB LATCH
- 4. FLOW HANDLE
- 5. GROUND CLIP

- 6. GROUND PLUG
- 7. CAM-LOCK COUPLING (AE83206R ONLY)
- 8. DUST PLUG (AE83206R ONLY)
- 9. UNISEX COUPLING (AE83501R ONLY)
- 10. DUST CAP (AE83501R ONLY)

Figure 1-1. CCR Nozzle Assembly

CHAPTER 1

INTRODUCTION

Section I. GENERAL INFORMATION

1-1. SCOPE. This Operator's, Organizational, and Direct Support Maintenance Manual and Repair Parts and Special Tools List covers operation, maintenance, test, and repair procedures for the Closed Circuit Refueling Nozzle (models AE83206R and AE83501R), hereafter referred to as "CCR nozzle", "nozzle assembly", or "nozzle". The purpose of the CCR nozzle is to dispense aviation fuel to aircraft.

1-2. MAINTENANCE FORMS, RECORDS, AND REPORTS. Department of the Army forms and procedures used for equipment maintenance will be those prescribed by DA PAM 738-750, The Army Maintenance Management System (TAMMS).

1-3. DESTRUCTION OF ARMY MATERIEL TO PREVENT ENEMY USE. This equipment shall be destroyed in accordance with TM 750-244-3, Procedures for Destruction of Equipment to Prevent Enemy Use.

1-4. PREPARATION FOR STORAGE OR SHIPMENT. See Chapter 4, Section V, Preparation For Storage or Shipment.

1-5. REPORTING EQUIPMENT IMPROVEMENT RECOMMENDATIONS (EIR'S). If your nozzle assembly needs improvement, let us know. Send us an EIR. You, the user, are the only one who can tell us what you don't like about your equipment. Let us know why you don't like the design or performance. Put it on a SF 368 (Quality Deficiency Report). Mail it to us at: Commander, U.S. Army Aviation and Troop Command, ATTN: AMSAT-I-MDO, 4300 Goodfellow Blvd., St. Louis, MO 63120-1798. We will send you a reply.

1-6. WARRANTY INFORMATION. The nozzle assembly is warranted by Aeroquip Corporation for one year from date of original delivery. Warranty starts on the date found on DA Form 2410 or DA Form 2408-16 in the logbook. Report all defects in material or workmanship to your supervisor who will take appropriate action.

Section II. EQUIPMENT DESCRIPTION AND DATA

1-7. EQUIPMENT CHARACTERISTICS, CAPABILITIES, AND FEATURES. (See Figure 1-1.)

CHARACTERISTICS:

- * Light weight. Can be hand carried to and from aircraft.
- * Manually operated.
- * Complete nozzle assembly. Includes protective caps and grounding connectors.